









Visitor map

Hatton Gallery

-  Dim lights
-  Bright light
-  Flashing light
-  Background noises
-  Loud noises
-  Temperature changes
-  Seating

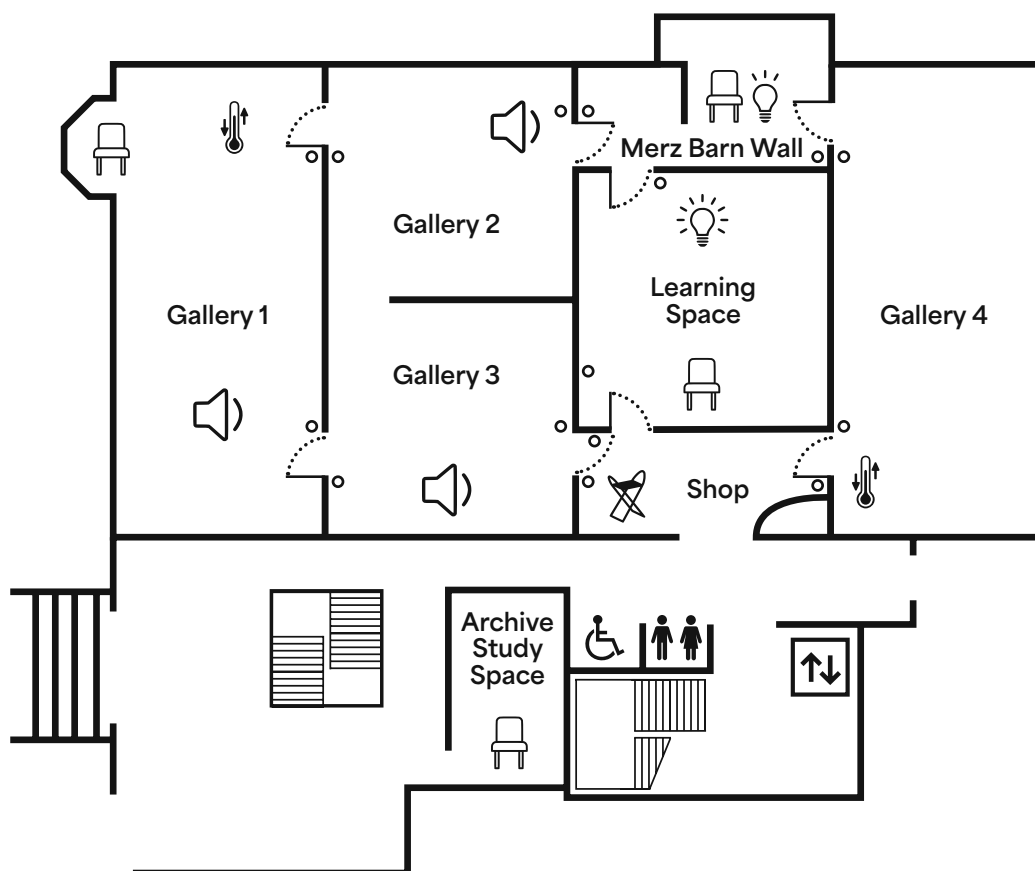
Ground Floor



 Our galleries are connected by automatic doors that are opened using touchpads. These touchpads are marked out on the map along with the direction the door will open.

 Gallery 1 and 3 have creaky wooden floors.

 There are air conditioners that produce white noise in Gallery 2, 3 and the Merz Barn Wall.

Please speak to a member of staff to access the Archive Study Space or book for another time.